

THIS DRAWING IS UNPUBLISHED. RELEASED FOR PUBLICATION
 © COPYRIGHT - By - ALL RIGHTS RESERVED.

LOC		DIST		REVISIONS			
P	LTR	DESCRIPTION		DATE	DWN	APVD	
AF	50	B1	REVISED PER ECR-11-025318		19DEC11	KH	GJ

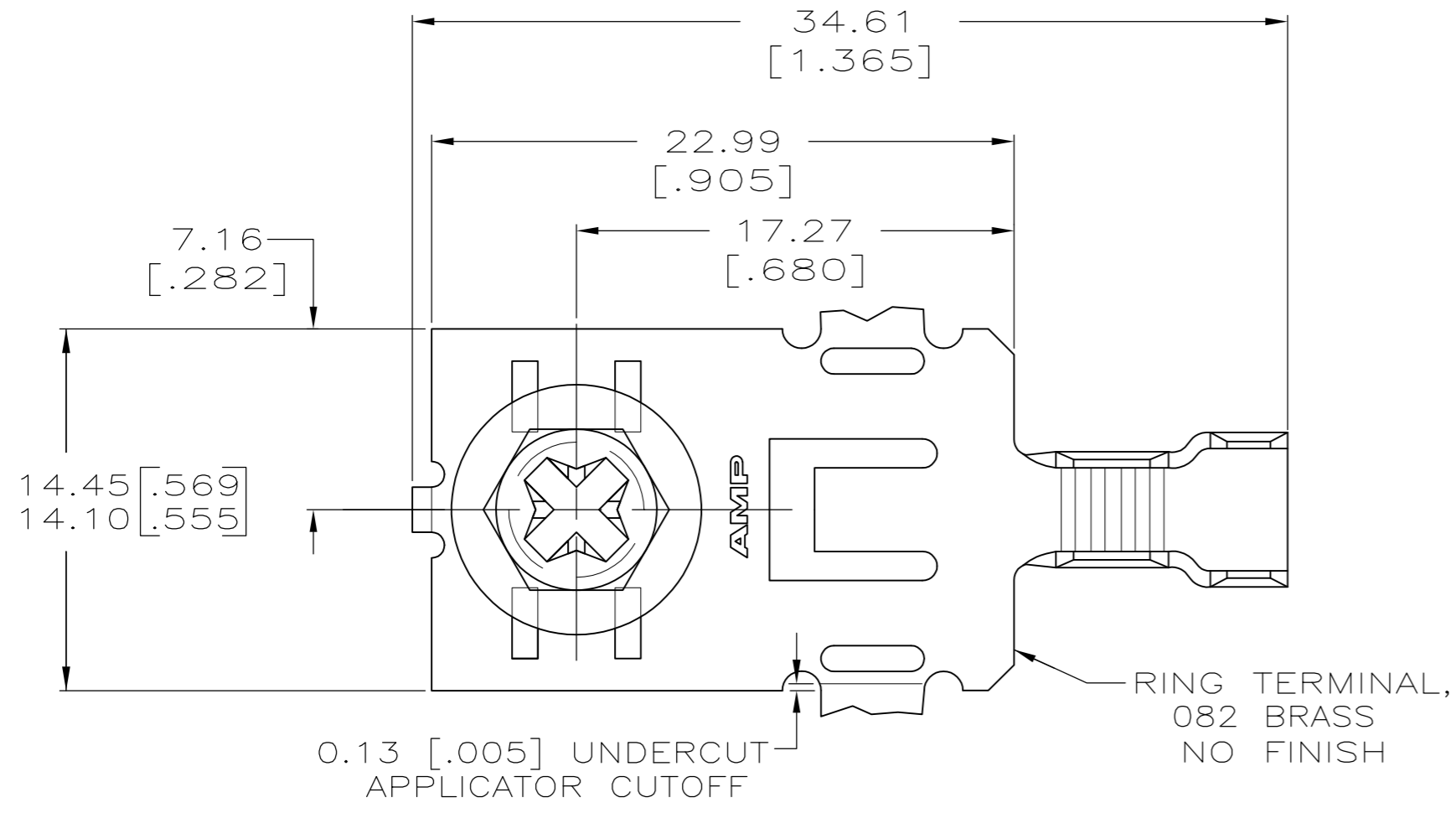

- 1 CONTINUOUS STRIP ON REEL.
- 2 VERTICAL BURRS NOT TO EXCEED 0.13 [.005] ALONG THIS EDGE.
- 3 BACK OUT TORQUE OF SCREW TO BE A MIN OF 5 INCH LBS AND A MAX OF 25 INCH LBS.
- 4 REFERENCE APPLICATOR LOG SHEET FOR CRIMP INFORMATION.
- 5 PART TO HAVE HARDENED NUTS

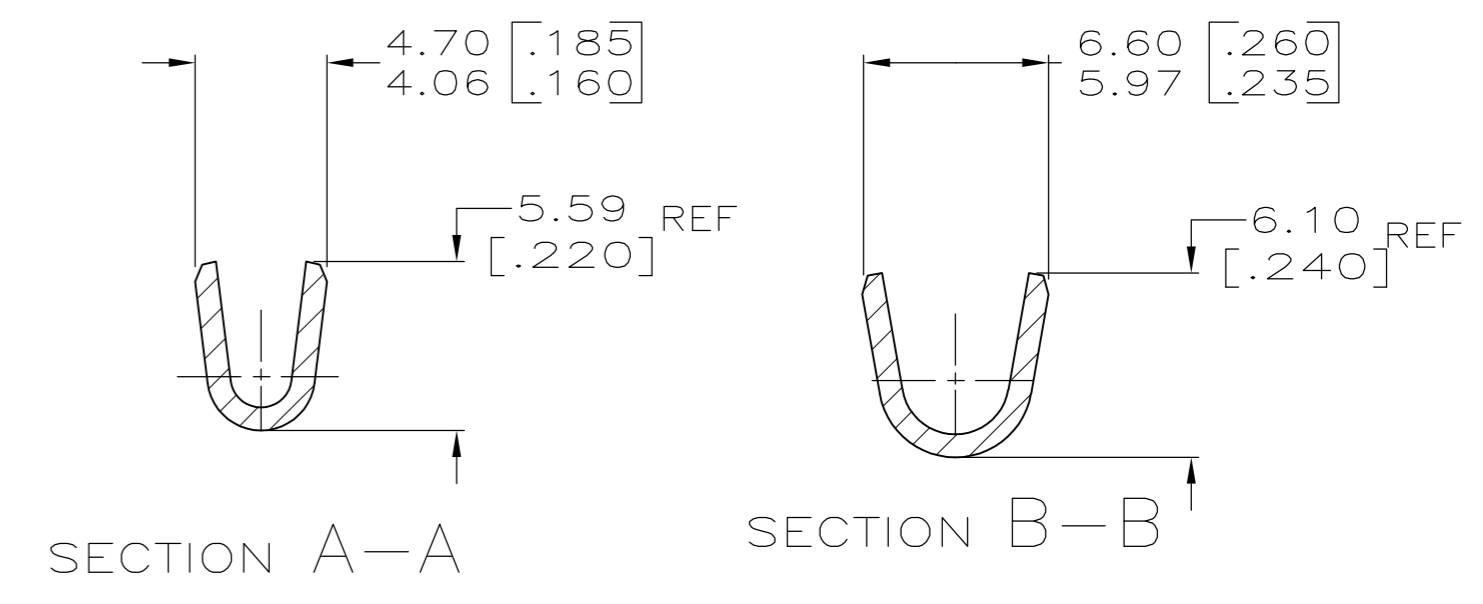
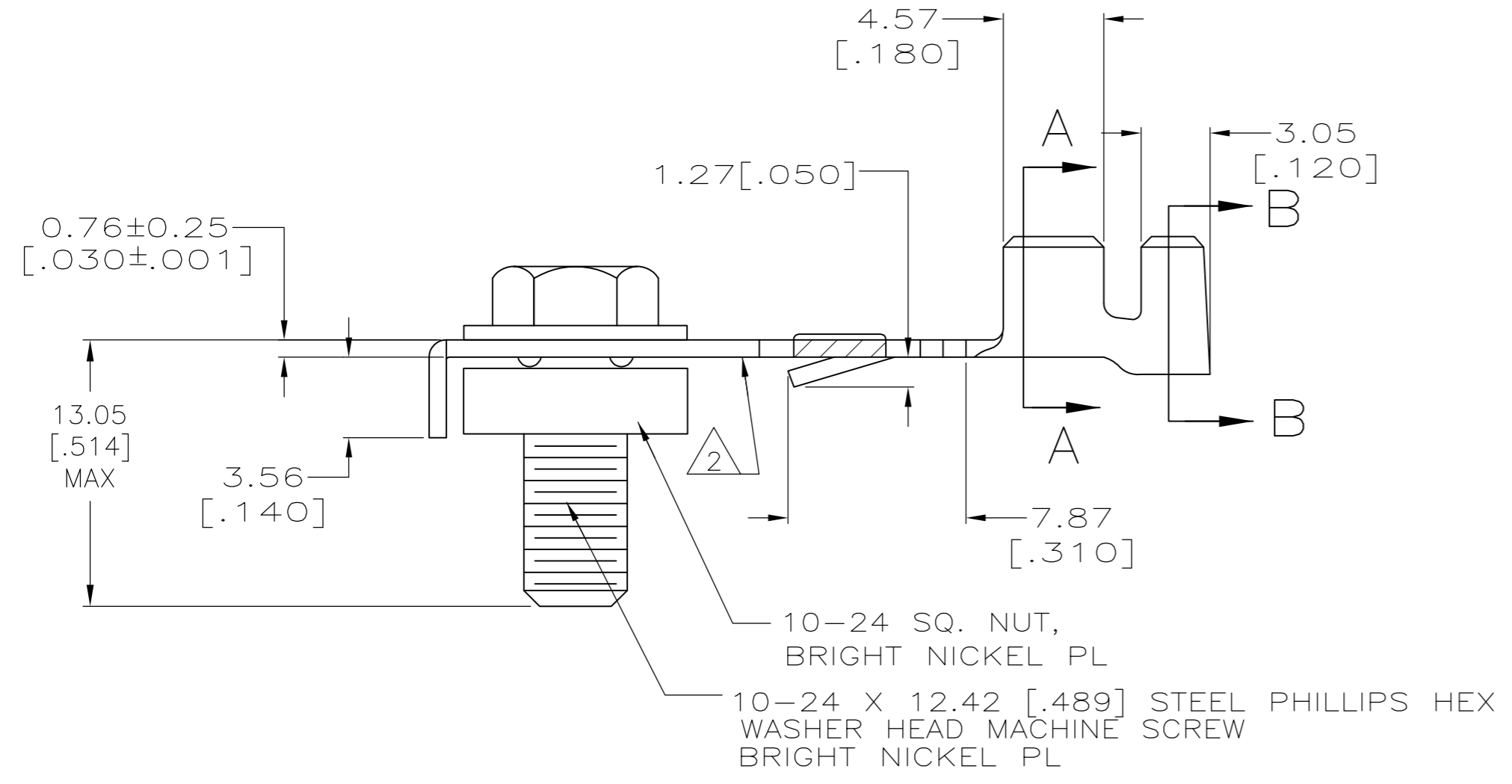

2.79-4.06 [.110-.160] DIA	#16-#12 AWG	521844-1
INSULATION RANGE	WIRE RANGE	PART NUMBER

THIS DRAWING IS A CONTROLLED DOCUMENT.		DWN	JR RUTH	13SEP05		TE Connectivity							
DIMENSIONS: mm [INCHES]		CHK	DONALD DECKER	13SEP05		NAME							
TOLERANCES UNLESS OTHERWISE SPECIFIED:		APVD	DONALD DECKER	13SEP05		PRODUCT SPEC							
0 PLC ± - 1 PLC ± - 2 PLC ± 0.38[.015] 3 PLC ± - 4 PLC ± - ANGLES ± -		APPLICATION SPEC		108-1191		TERMINAL, SUB-ASSEMBLY, POWER RING							
MATERIAL	SEE COMPONENT	FINISH	SEE COMPONENT	WEIGHT	-	SIZE	A2	CAGE CODE	00779	DRAWING NO	C=521844	RESTRICTED TO	-
CUSTOMER DRAWING		SCALE		4:1	SHEET		1 OF 1	REV		B1			